



WELD-ON-HINGES

• MILD STEEL • STAINLESS • ALUMINUM •



FES
8 Inch



FES
6 Inch



FES
4 Inch



FES
3 3/16 Inch



FES
2 Inch

- Tear-drop Profile
- High Load Capacity
- Professional Appearance
- Ideal For Gates, Toolboxes, Doors, Trailers, BBQs, Etc.
- Permits Smooth Operation
- Eliminates Fasteners & Unsightly Leaves
- Can Be Welded On As Lift-off or Permanently Mounted
- Paintable To Match Door or Frame
- Can Be Galvanized
- Available With Grease Fittings

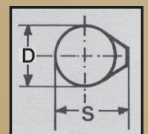
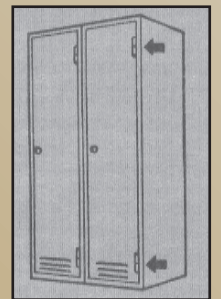
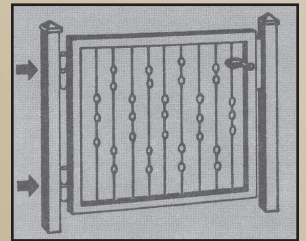

www.intercononline.com

Scale 1:1
10" also Available

STEEL

WELD-ON-HINGES STEEL:

- Made from special profile steel for weld-on applications
- Esthetic half-round heads and 360° rotation of V-shaped flanges allow for ease of weld-on installation
- Brass washer on each hinge permits smooth continuous operation

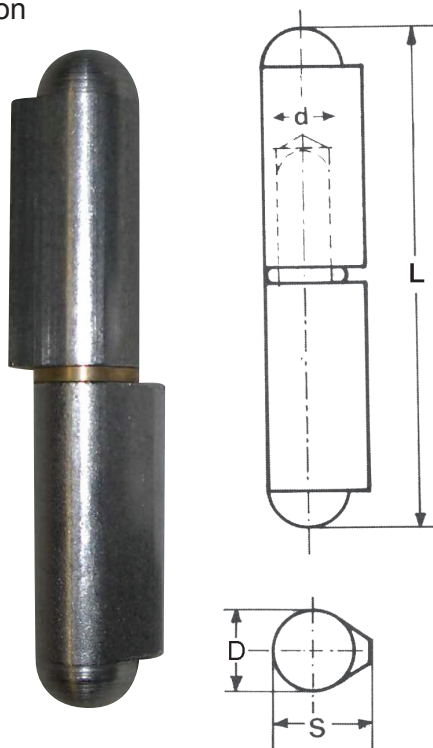

FIXED PIN TYPE:

FES - Mild Steel (1015) with case-hardened steel pin and brass washer

FMS* - Mild Steel (1015) with brass pin and brass washer

**Model Brass Pins' load capacity is 20% less than listed*

| Model Steel Pin | Model* Brass Pin | L Length inches | D/S Cross Section inches | d Pin Diameter inches | Weight Load Per Pair lbs. * |
|-----------------|------------------|-----------------|---|-----------------------|-----------------------------|
| FES050 | FMS050 | 2" | 5/16" - 13/32" | 3/16" | 150 |
| FES060 | FMS060 | 2.3/8" | 13/32" - 15/32" | 1/4" | 185 |
| FES070 | n/a | 2.3/4" | 7/16" - 17/32" | 9/32" | 185 |
| FES080 | FMS080 | 3.3/16" | 1/2" - 5/8" | 5/16" | 300 |
| FES090 | n/a | 3.1/2" | 9/16" - 23/32" | 11/32" | 300 |
| FES100 | FMS100 | 4" | 5/8" - 3/4" | 13/32" | 440 |
| FES120 | n/a | 4.3/4" | 5/8" - 3/4" | 7/16" | 440 |
| FES135 | n/a | 5.1/4" | 23/32" - 29/32" | 15/32" | 550 |
| FES150 | FMS150 | 6" | 3/4" - 1" | 1/2" | 650 |
| FES180 | FMS180 | 7" | 3/4" - 1" | 9/16" | 650 |
| FES200 | FMS200 | 8" | 29/32" - 1.1/8" | 5/8" | 800 |
| FES260 | n/a | 10" | Available with Grease Fitting only: See table below | | |

STEEL WITH GREASE FITTING

WELD-ON-HINGES WITH GREASE FITTING:

- Made from special profile steel for weld-on applications
- Esthetic half-round heads and 360° rotation of V-shaped flanges allow for ease of weld-on installation
- Brass washer on each hinge permits smooth continuous operation
- Zirc fitting allows for additional lubrication (grease) to be applied to hinges with high duty cycles, exposure to intermittent moisture or high humidity

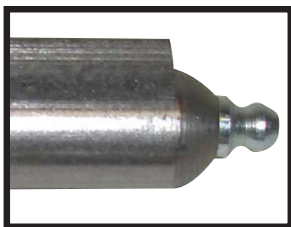

FIXED PIN TYPE:

FES-GF - Mild Steel (1015) with case hardened steel pin, brass washer and grease fitting

FMS-GF* - Mild Steel (1015) with brass pin and brass washer

**Model Brass Pins' load capacity is 20% less than listed*

| Model Steel Pin | Model* Brass Pin | L Length inches | D/S Cross Section inches | d Pin Diameter inches | Weight Load Per Pair lbs. * |
|-----------------|------------------|-----------------|--------------------------|-----------------------|-----------------------------|
| FES080GF | FMS080GF | 3.3/16" | 1/2" - 5/8" | 5/16" | 300 |
| FES100GF | FMS100GF | 4" | 5/8" - 3/4" | 13/32" | 440 |
| FES120GF | FMS120GF | 4.3/4" | 5/8" - 3/4" | 7/16" | 440 |
| FES150GF | FMS150GF | 6" | 3/4" - 1" | 1/2" | 650 |
| FES200GF | FMS200GF | 8" | 29/32" - 1.1/8" | 5/8" | 800 |
| FES260GF | FMS260GF | 10" | 1.1/8" - 1.7/16" | 3/4" | 1000 |

ALUMINUM

WELD-ON-HINGES ALUMINUM:

- Made from special profile aluminum for weld-on applications
- Esthetic half-round heads and 360° rotation of V-shaped flanges allow for ease of weld-on installation
- With stainless washer

| Model | Model Grease Fitting | L Length inches | D/S Cross Section inches | d Pin Diameter inches | Weight Load Per Pair lbs. * |
|--------|----------------------|-----------------|--------------------------|-----------------------|-----------------------------|
| ALU060 | n/a | 2.3/8" | 13/32" - 15/32" | 1/4" | 200 |
| ALU080 | n/a | 3.3/16" | 1/2" - 5/8" | 5/16" | 350 |
| ALU100 | ALU100GF | 4" | 5/8" - 3/4" | 13/32" | 500 |
| ALU150 | ALU150GF | 6" | 3/4" - 1" | 1/2" | 650 |

FIXED PIN TYPE:

ALU - Aluminum (6063) with stainless steel pin and stainless washer

STAINLESS STEEL

WELD-ON-HINGES STAINLESS STEEL:

- Made from special profile stainless steel for weld-on applications
- Esthetic half-round heads and 360° rotation of V-shaped flanges allow for ease of weld-on installation
- With stainless washer

| Model | Model Grease Fitting | L Length inches | D/S Cross Section inches | d Pin Diameter inches | Weight Load Per Pair lbs. * |
|--------|----------------------|-----------------|--------------------------|-----------------------|-----------------------------|
| V2A060 | n/a | 2.3/8" | 13/32" - 15/32" | 1/4" | 400 |
| V2A080 | n/a | 3.3/16" | 1/2" - 5/8" | 5/16" | 600 |
| V2A100 | V2A100GF | 4" | 5/8" - 3/4" | 13/32" | 750 |
| V2A150 | V2A150GF | 6" | 3/4" - 1" | 1/2" | 900 |
| V2A200 | V2A200GF | 8" | 29/32" - 1.1/8" | 5/8" | 1200 |

FIXED PIN TYPE:

V2A - Stainless steel (304) with stainless steel pin and stainless washer

STEEL 3 PIECE HEAVY DUTY

WELD-ON-HINGES 3 PIECE:

- Made from special profile steel for weld-on applications
- Pin with half-round head and sections with V-shaped flanges allow for ease of weld-on installation
- With brass washers



REMOVABLE PIN TYPE:

A3E - Mild Steel (1015) with case hardened steel pin and brass washers. A locking "snap ring" washer at the end of the removable pin, keeps the pin in place.

| Model | L Length inches | D/S Cross Section inches | d Pin Diameter inches | Weight Load Per Hinge lbs. * |
|--------|-----------------|--------------------------|-----------------------|------------------------------|
| A3E135 | 5.1/4" | 23/32" - 29/32" | 15/32" | 1500 |
| A3E150 | 6" | 3/4" - 1" | 1/2" | 2000 |
| A3E180 | 7" | 3/4" - 1" | 9/16" | 2900 |
| A3E200 | 8" | 29/32" - 1.1/8" | 5/8" | 4000 |

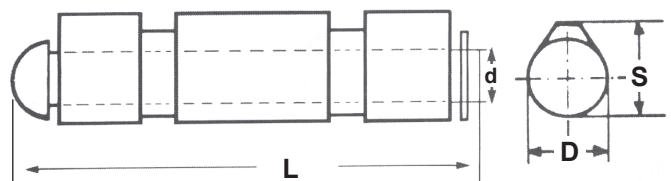

STEEL REMOVABLE PIN

WELD-ON-HINGES 2 PIECE WITH REMOVABLE STEEL PIN:

- Made from special profile steel for weld-on applications
- Pin with half-round head and sections with V-shaped flanges allow for ease of weld-on installation
- With brass washer

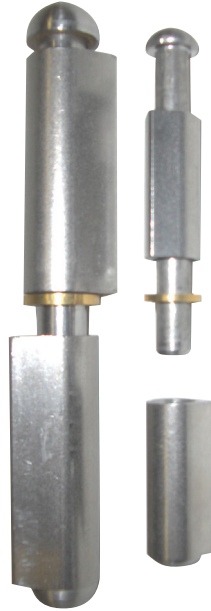

REMOVABLE PIN TYPE:

AES - Mild steel (1015) with removable steel pin and brass washer

| Model | L Length inches | D/S Cross Section inches | d Pin Diameter inches | Weight Load Per Pair lbs. * |
|--------|-----------------|--------------------------|-----------------------|-----------------------------|
| AES050 | 2" | 5/16" - 13/32" | 3/16" | 110 |
| AES080 | 3.3/16" | 1/2" - 5/8" | 5/16" | 240 |
| AES100 | 4" | 5/8" - 3/4" | 13/32" | 420 |
| AES150 | 6" | 3/4" - 1" | 1/2" | 530 |
| AES200 | 8" | 29/32" - 1.1/8" | 5/8" | 660 |

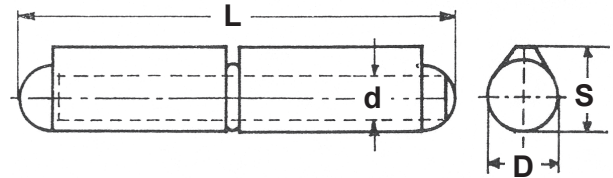

Weld on Applications

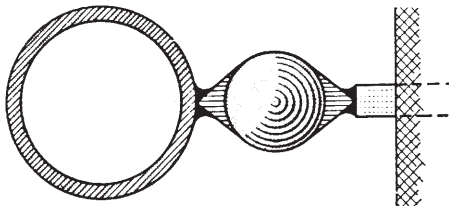
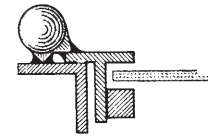
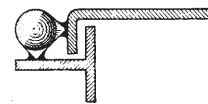
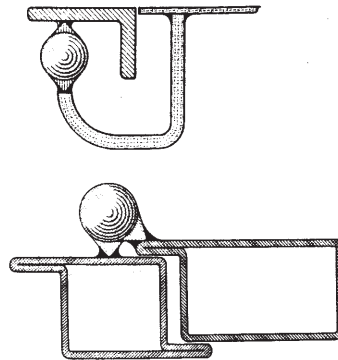
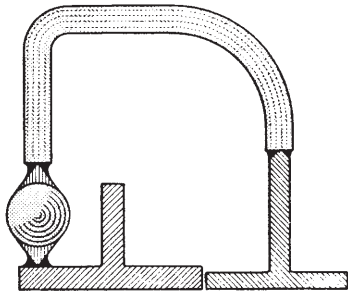

Avoid welding onto the hinge body (shaded area).

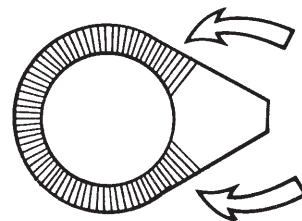

***IMPORTANT:** The printed weight loads should be used as a general guideline only. Load compensation should be made when determining the size and number of hinges for applications that may be subject to dynamic forces (shock loads), areas where the pin is set in a horizontal position, and other uses that create extra pin stress (ie. long gates, wide doors, etc.). Addition of heat-resistant molybdenum or lithium-based greases to the hinge's internal body before final assembly is recommended and may provide freer movement and a longer life. No guarantee for weight loads and dimensions.



1125 Fir Ave.
Blaine, WA 98230 USA
Tel: (800) 665-6655
Fax: (604) 946-5340

Unit 11 - 7550 River Rd.
Delta, BC V4G 1C8 CANADA
Tel: (604) 946-6066
Fax: (604) 946-5340

sales@intercononline.com www.intercononline.com

DISTRIBUTOR: